

**ORDINANCE NUMBER 14-008**  
**(Case Z-03-14, Zoning Request from R-2 to C-MH)**

**AN ORDINANCE OF THE CITY OF SAFFORD, GRAHAM COUNTY, ARIZONA EFFECTUATING A MAP AMENDMENT TO THE ZONING MAP OF THE CITY OF SAFFORD, GRAHAM COUNTY ASSESSOR'S PARCEL NUMBER #101-09-057, A REZONE FROM R-2 (MULTI-FAMILY RESIDENTIAL) TO C-MH (CONVENTIONAL AND MANUFACTURED HOME).**

**WHEREAS**, the City of Safford desires to facilitate land uses consistent with the general plan authorized by the voters; and,

**WHEREAS**, the Planning & Zoning Commission has recommended the attached zoning map amendment (Exhibit A), Graham County Assessor's Parcel #101-09-057, a rezone from R2 (Multi-Family Residential) to C-MH (Conventional and Manufactured Home); and,

**WHEREAS**, the City Council finds that the proposed change is desirable and in accordance with applicable laws, ordinances and regulations; and

**WHEREAS**, the City Council also finds that Chapters 2.08 and 17.20 of the *City of Safford Municipal Code* have been satisfied as they relate to amendment of the City of Safford Municipal Code; and,

**NOW THEREFORE BE IT ORDAINED** by the Mayor and City Council of the City of Safford, that the official zoning map of the City of Safford as described in Section 17.24.020 of the *City of Safford Municipal Code* is hereby amended as set out in the attached Exhibit A, all as attached and incorporated herein.

**PASSED, APPROVED AND ADOPTED** by the Mayor and City Council of the City of Safford, Graham County, Arizona this 23rd day of June, 2014 with an effective date of the 24<sup>th</sup> day of July, 2014.

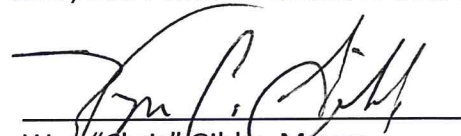
  
\_\_\_\_\_  
Wyn "Chris" Gibbs, Mayor  
City of Safford

ATTEST:

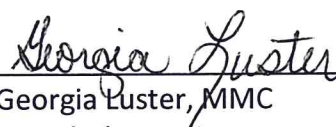
  
\_\_\_\_\_  
Georgia Luster, MMC  
City Clerk

APPROVED AS TO FORM:

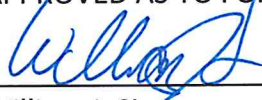
  
\_\_\_\_\_  
William J. Sims  
Interim City Attorney

Ordinance Number 14-008  
Adopted: June 23, 2014  
Effective: July 24, 2014  
Page 2

STATE OF ARIZONA    )  
                                  )    ss  
County of Graham    )

CERTIFICATION

I HEREBY CERTIFY, that the foregoing Ordinance Number 14-008 was duly passed and adopted by the Mayor and City Council of the City of Safford, Graham County, Arizona, at a special council meeting held June 23, 2014 with an effective date of July 24, 2014. A quorum of the Council was present at the meeting.

Georgia Luster  
Georgia Luster, MMC  
City Clerk

June 23, 2014  
Date:

Exhibit A

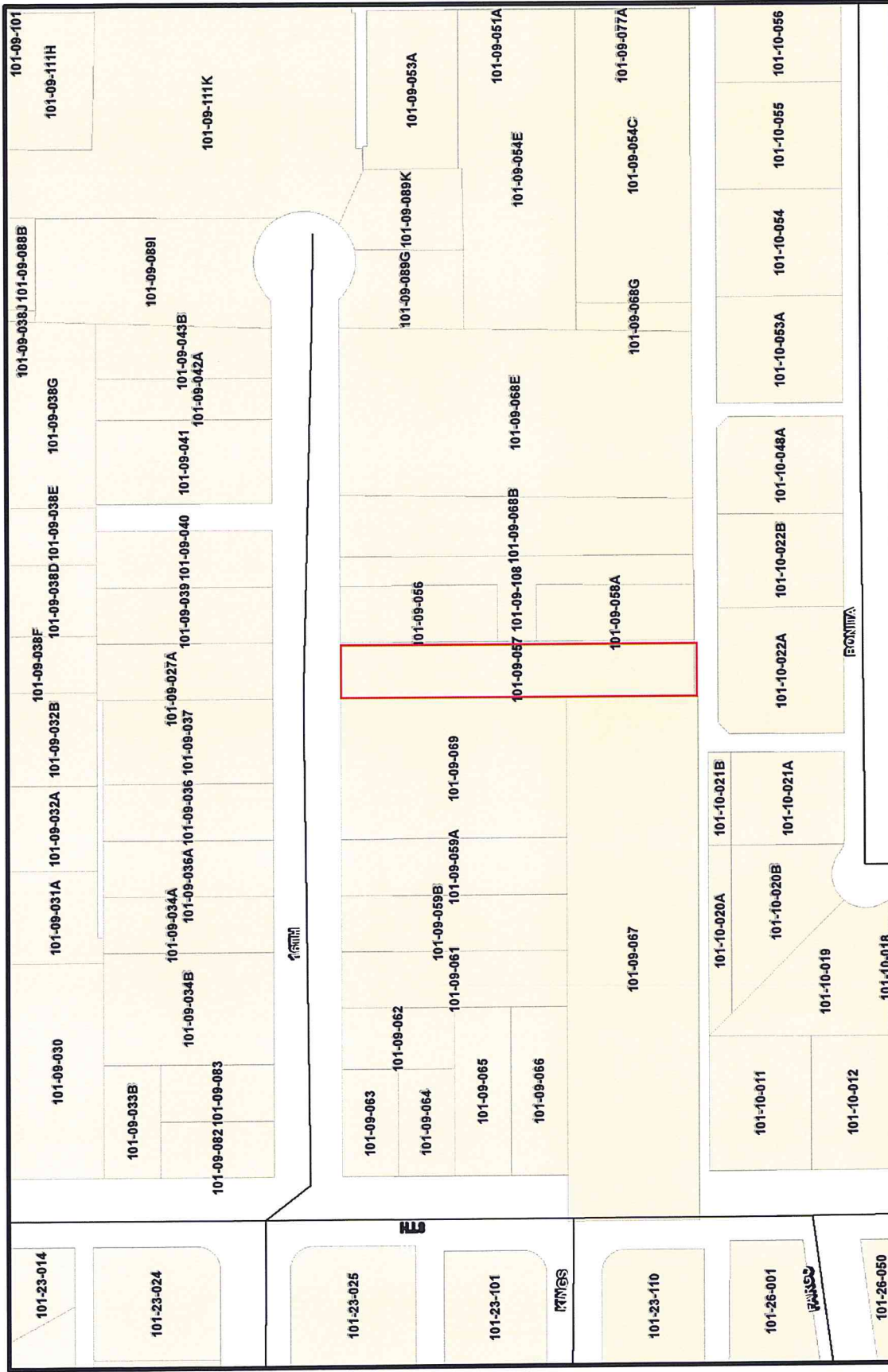

Graham County Parcel # 101-09-057

BEGINNING AT A POINT 1001.01 FEET TO THE South and 466 feet East of the Northwest Corner of the Southwest Quarter of Section 17, Township 7 South, Range 26 East of the Gila & Salt River Base and Meridian in Graham County, Arizona; running thence South 313.99 feet; thence East 100 feet; thence North 140 feet; thence North 173.99 feet; thence West 50 feet to the point of beginning.